

**NOTICE**

DO NOT AT ANY TIME ATTACH WEAR INSERT OR REMOVE WEAR INSERT FROM SEED FIRMER WHILE ATTACHED TO PLANTER. REMOVE SEED FIRMER WHILE DOING MAINTENANCE. BEWARE OF ALL PINCH POINTS. DO NOT BACKUP PLANTER WHILE FIRMER IS DOWN. **ALWAYS** BE MOVING FORWARD WHEN LOWERING PLANTER.

**Foam Tip**

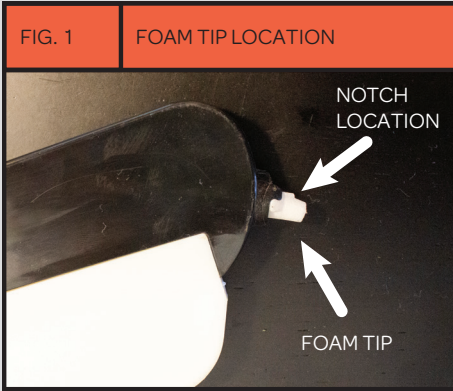

**Fig. 1** Above Shows the location of the foam tip on the Firmer. The raised triangle notch goes on top.

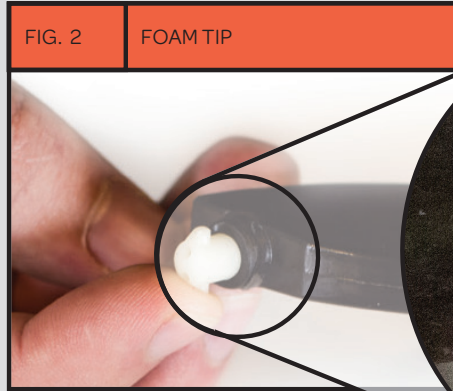

**Fig 2** The image pictured shows a close up of the foam tip that is part of this Firmer part.

For questions, ordering, replacing, or any other inquiries please call **1-800-247-2167**

**WARRANTY**

Flo-rite® Seed Firmers are warranted to be free of defects in material and workmanship for one year from date of installation, any other warranty, such as merchantability or fitness for a particular purpose, is expressly disclaimed. Our obligation under this warranty shall be limited to repairing or replacing, free of charge to the original purchaser, any part that in our judgment shall show evidence of such defect, provided further that such part shall be returned within thirty (30) days from the date of failure - routed through the dealer from whom the purchase was made. Shipping charges prepaid. Covered by U.S. Patent Nos. 9,565,797 and 10,149,426 and other pending U.S. and International Patents.

Flo-rite® Seed Firmers shall have no liability of any kind, except for the warranty above, on account of any of its products and shall not be liable for special or consequential damages. Flo-rite® Seed Firmers shall not be liable for indirect, incidental or consequential damages or injuries including but not limited to loss of crops, loss of profits, rental of substitute equipment, planting delays, any expense or loss incurred for labor, other commercial loss or for any other reason. Covered by U.S. Patent Nos. 9,565,797 and 10,149,426 and other pending U.S. and International Patents.

**WARNING: Never backup planter with seed firmers down. This may break and/or damage firmer or wear inserts.**